

◆ Main Specifications

| | | |
|---|-----------------------------|---|
| Heat-Resistant Class | | Class H (180 °C) |
| Rated Voltage | | 12 (V DC) |
| DC Resistance | | 35 (Ω) |
| Coil Saturation Temperature Rise $\Delta\theta_s$ (at 20 °C) | | $\Delta\theta_s \doteq 36 \times W$ (°C) K $\doteq 36$ (°C/watt) |
| Temperature Rise Time Constant τ | | 6 (minutes) |
| Mass | | 22 (g) |
| Shutter Dimensions | | ϕ 15.2 (mm) |
| Operating Angle | | 50 (°) |
| Life Cycle/Durability | | 5,000,000 (cycles) |
| Response Speed | with Applied Voltage 3V DC | — |
| | with Applied Voltage 5V DC | — |
| | with Applied Voltage 12V DC | 15 (msec) or less |

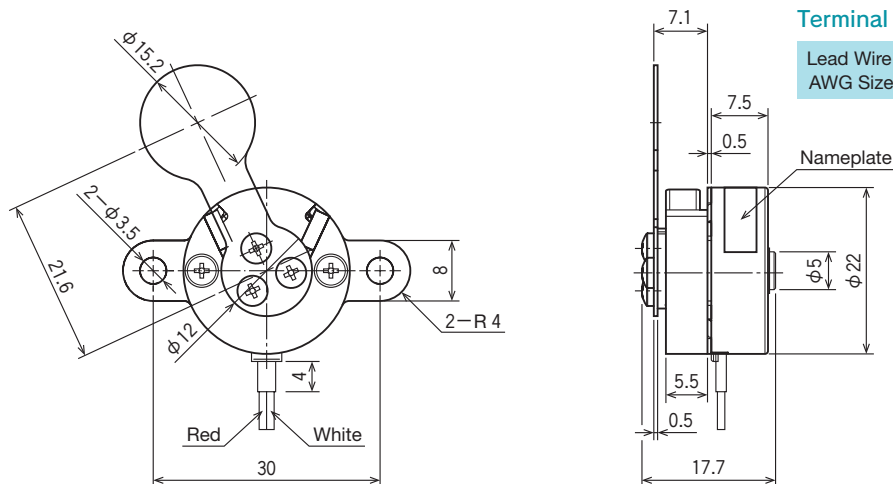

◆ External Dimensions (mm)



Terminal Specifications

Lead Wire Length (mm) : 320
AWG Size: 28

- In this diagram, the shutter is shown magnetically latched to the counterclockwise side.
- When a positive electrode is connected to the Red lead and a negative to the White, the shaft rotates clockwise; when a negative electrode is connected to the Red lead and a positive to the White, the shaft rotates counter-clockwise.

◆ How to Mount

