

◆ Main Specifications

Heat-Resistant Class		Class E (120 °C)
Rated Voltage		3 (V DC)
DC Resistance		9.5 (Ω)
Coil Saturation Temperature Rise Δθ _s (at 20 °C)		Δθ _s ≐ 59 × W (°C) K ≐ 59 (°C/watt)
Temperature Rise Time Constant τ		1 minute
Mass		4 (g)
Shutter Dimensions		12.3 × 10.3 (mm)
Operating Angle		50 (°)
Life Cycle/Durability		5,000,000 (cycles)
Response Speed	with Applied Voltage 3V DC	18 (msec) or less
	with Applied Voltage 5V DC	13 (msec) or less
	with Applied Voltage 12V DC	—

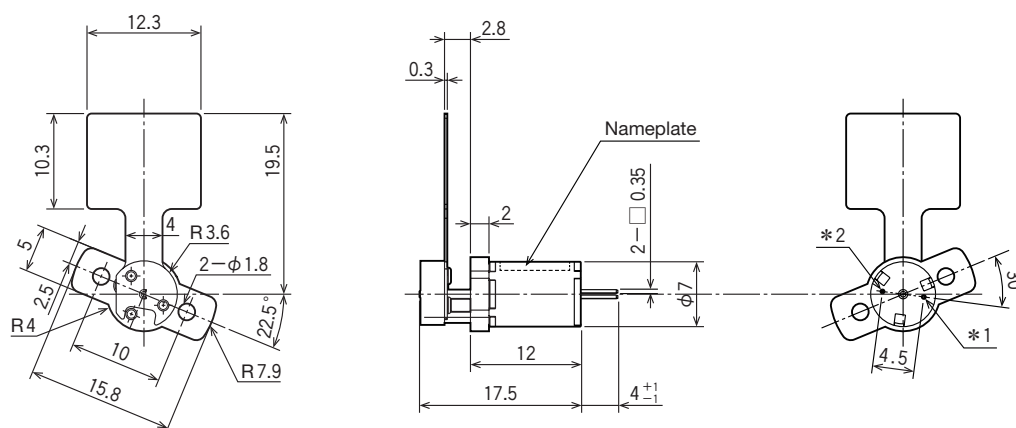

◆ External Dimensions (mm)



- In this diagram, the shutter is shown magnetically latched to the counterclockwise side.
- When a positive electrode is connected to *1 and a negative to *2, the shaft rotates counter-clockwise; when a negative electrode is connected to *1 and a positive to *2, the shaft rotates clockwise.

◆ How to Mount

